

BS 949.3 TAP BLANK DIMENSIONS FOR PARALLEL PIPE THREADS BSP(G) AND Rp SERIES

THREAD SIZE" BSP	BASIC MAJOR DIAMETER D	THREADS PER INCH (TPI)	Dimensions in millimetres					NUMBER OF FLUTES		
			OVERALL LENGTH L	THREAD LENGTH L1	SHANK DIAMETER D1	SQUARE LENGTH L3	SQUARE A/F	STRAIGHT FLUTE	SPIRAL POINT	SPIRAL FLUTE
1/16	7.723	28	52	14	5.6	7	4.5	4	3	3
1/8	9.728	28	59	15	8.0	9	6.3	4	3	3
1/4	13.157	19	67	19	10.0	11	8.0	4	3	3
3/8	16.662	19	75	21	12.5	13	10.0	4	3	3
1/2	20.995	14	87	26	16.0	16	12.5	4	3	3
5/8**	22.911	14	91	26	18.0	18	14.0	4	3	3
3/4	26.441	14	96	28	20.0	20	16.0	4	3	3
7/8**	30.201	14	102	29	22.4	22	18.0	4	3	3
1"	33.249	11	109	33	25.0	24	20.0	4/6	4	4
1.1/8**	37.897	11	115	34	28.0	26	22.4	4/6		
1.1/4	41.910	11	119	36	31.5	28	25.0	4/6		
1.1/2	47.803	11	125	37	35.5	31	28.0	4/6		
1.3/4**	53.746	11	132	39	35.5	31	28.0	6		
2"	59.614	11	140	41	40.0	34	31.5	6		
2.1/4**	65.710	11	142	42	40.0	34	31.5	6/8		
2.1/2	75.184	11	153	45	45.0	38	35.5	6/8		
2.3/4**	81.534	11	160	46	50.0	42	40.0	6/8		
3"	87.884	11	164	48	50.0	42	40.0	6/8		
3.1/2**	100.330	11	173	50	63.0	51	50.0	8/10		
4"	113.030	11	185	53	71.0	56	56.0	10		

** G series only. Non preferred nominal sizes as per BS2779 (Basic thread dimensions and tolerances).

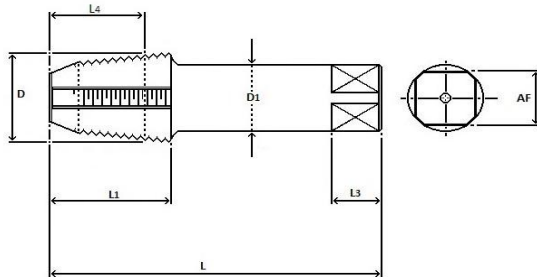

BS 949.3 TAP BLANK DIMENSIONS FOR TAPER PIPE THREADS Rc SERIES

THREAD SIZE" BSPT (Rc)	GAUGE PLANE DIAMETER D	THREADS PER INCH (TPI)	Dimensions in millimetres					Straight flute only		
			OVERALL LENGTH L	THREAD LENGTH L1	SHANK DIAMETER D1	MAX LENGTH FWD OF GAUGE PLANE L4	SQUARE LENGTH L3	SQUARE A/F	NUMBER OF FLUTES	
1/16	7.723	28	52	14	5.6	10.1	7	4.5	4	
1/8	9.728	28	59	15	8.0	10.1	9	6.3	4	
1/4	13.157	19	67	19	10.0	15.0	11	8.0	4	
3/8	16.662	19	75	21	12.5	15.4	13	10.0	4	
1/2	20.955	14	87	26	16.0	20.5	16	12.5	4	
3/4	26.441	14	96	28	20.0	21.8	20	16.0	5	
1"	33.249	11	109	33	25.0	26.0	24	20.0	5	
1.1/4	41.910	11	119	36	31.5	28.3	28	25.0	5	
1.1/2	47.803	11	125	37	35.5	28.3	31	28.0	7	
2"	59.614	11	140	41	40.0	32.7	34	31.5	7	
2.1/2	75.184	11	153	45	45.0	37.1	38	35.5		
3"	87.884	11	164	48	50.0	40.2	42	40.0		
4"	113.030	11	185	53	71.0	46.2	56	56.0		

Note. Old stock may be to ASME B94.9. (See American Pipe).